

8" CYLINDER VERTICAL LAMP UP/DOWNLIGHT

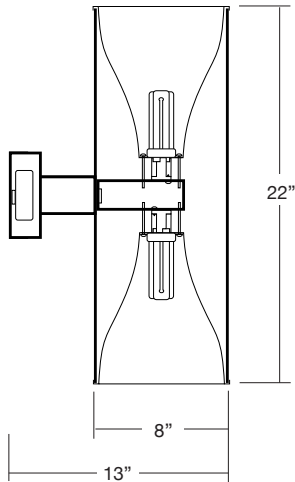

Wall Mount Cylinder



Clear Alzak® Haze



Wheat Alzak® Haze



Black Baffle

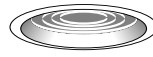

Splay with
Fresnel Lens

SPECIFICATION INFORMATION

CYLINDER HOUSING

Constructed of seamless extruded aluminum, with a powder coat finish. 14" standard height; dimming and emergency ballast add 4". Fixture mounts to standard J-box.

REFLECTOR

Reflector is anodized, specular, durable and anti-iridescent; available in 30° cutoff (.30). Finishes are **A**—Clear Alzak® Haze or **G**—Wheat Alzak® Haze

TRIM OPTIONS

B—Black baffle
SP—Splay Fresnel Lens

BALLAST

Electronic enclosed, class P, HPF is supplied standard in 120V or 277V. Ballasts use 4-pin lamps and provide rapid start, .99 power factor with THD<10%.

ELECTRICAL

Ballast mounted in canopy for easy access. U.L. listed for use in damp locations. For wet locations, specify convex lens **WL**.

ACCESSORIES

WL—Wet location convex lens

FINISHES

BM—Brushed Metal, Anodized
BZ—Bronze
K—Black
W—White
S—Silver
CC—Custom Color (Must specify RAL color number.)

ORDERING INFORMATION

LAMP

2-18 18W quad tube
2-26 26W quad tube
2-32 32W triple tube
2-42 42W triple tube

SPECIFY FINISH:

BM—Brushed Metal, anodized
BZ—Bronze
K—Black

120V ELECTRIC

CUV8218.1E 18W quad tube
CUV8226.1E 26W quad tube
CUV8232.1E 32W triple tube
CUV8242.1E 42W triple tube

W—White
S—Silver
CC—Custom Color
Specify RAL color #:

277V ELECTRIC

CUV8218.2E 18W quad tube
CUV8226.2E 26W quad tube
CUV8232.2E 32W triple tube
CUV8242.2E 42W triple tube

SUBMITTAL INFORMATION

TYPE:

PROJECT:

NOTES:

DESCRIPTION:

DELRAY
LIGHTING
INCORPORATED

CUV8200

BURBANK,
CALIFORNIA,
91505
WWW.
DELRAY
LIGHTING.
COM

NOV 2008

CLEAR ALZAK 30°

CUV8218

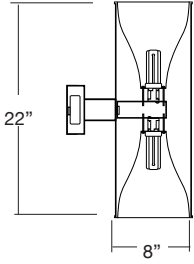

CLEAR ALZAK 30°

CUV8226

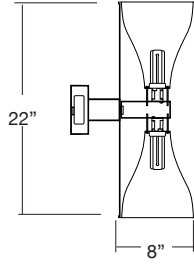

CLEAR ALZAK 30°

CUV8232

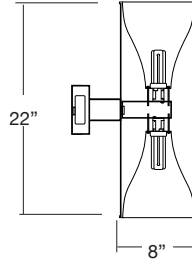

CLEAR ALZAK 30°

CUV8242

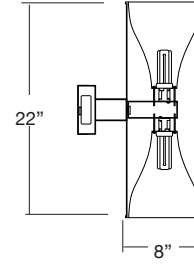

CONE OF LIGHT

MTG. HT.	FC/0°	DIA.
4'	65	3.7
6'	29	5.5
8'	17	7.3
10'	11	9.2
12'	8	11.0

50% FC at edge

MTG. HT.	FC/0°	DIA.
4'	81	3.7
6'	39	5.5
8'	19	7.3
10'	12	9.2
12'	9	11.0

50% FC at edge

MTG. HT.	FC/0°	DIA.
4'	95	4.2
6'	42	6.4
8'	24	8.5
10'	15	10.7
12'	11	12.8

50% FC at edge

MTG. HT.	FC/0°	DIA.
4'	123	4.3
6'	54	6.6
8'	31	8.8
10'	19	10.9
12'	14	12.9

50% FC at edge

CP DISTRIBUTION

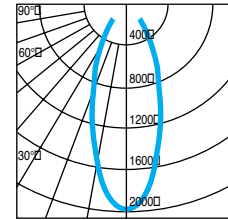
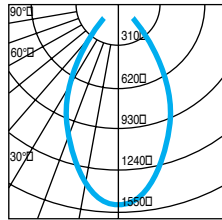
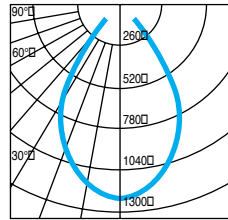
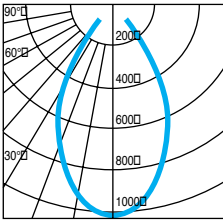

COEFFICIENTS OF UTILIZATION

	% CEILING 80 (20% FLOOR)		
	% WALL 70	50	30
0	75	75	75
1	72	71	70
2	70	67	65
3	67	64	61
4	64	60	58
5	62	57	54
6	59	55	52
7	57	52	49
8	54	49	46
9	52	47	43
10	50	44	41

	% CEILING 80 (20% FLOOR)		
	% WALL 70	50	30
0	71	71	71
1	69	67	66
2	66	63	61
3	63	60	57
4	61	57	54
5	58	53	50
6	55	51	48
7	53	48	45
8	50	45	42
9	48	43	39
10	46	40	37

	% CEILING 80 (20% FLOOR)		
	% WALL 70	50	30
0	84	84	84
1	80	78	77
2	77	74	71
3	73	69	66
4	70	65	62
5	67	61	57
6	63	58	54
7	60	54	50
8	57	50	46
9	54	47	43
10	51	44	40

	% CEILING 80 (20% FLOOR)		
	% WALL 70	50	30
0	79	79	79
1	76	74	73
2	73	70	67
3	69	66	63
4	66	62	58
5	63	58	55
6	60	55	51
7	57	51	48
8	54	48	44
9	51	45	41
10	49	42	39

NOTES

CUV8218

1-18W quad tube
G24q-2 electronic socket
Total lumens: 1250
Spacing criteria: .9
Wheat Alzak x.90

CUV8226

1-26W quad tube
G24q-3 electronic socket
Total lumens: 1800
Spacing criteria: .9
Wheat Alzak x.90

CUV8232

1-32W triple tube
G24q-3 electronic socket
Total lumens: 2400
Spacing criteria: .9
Wheat Alzak x.90

CUV8242

1-42W triple tube
G24q-4 electronic socket
Total lumens: 3200
Spacing criteria: .9
Wheat Alzak x.90